

# Quick Start Guide

Home Monitoring &  
Control System

HMGW1070  
USB Gateway



**MOTOROLA**  
*intelligence everywhere*



## Motorola Home Monitoring & Control System Overview

Congratulations on your purchase of the USB Gateway, the primary component of the Motorola Home Monitoring & Control System. This guide describes how to set up the USB Gateway.

The Motorola Home Monitoring & Control System helps keep you informed day and night, rain or shine. The complete product line offers many advanced monitoring devices, including:

- Wired and wireless video cameras
- Wireless temperature sensors
- Wireless water sensors
- Wireless door/window sensors

You can manage your system on your home PC. With a broadband Internet connection, you can specify e-mail and cell phone, as either a text message or as text + image, depending on your provider, for delivery of notifications based on monitored events.

For more information about Motorola Home Monitoring & Control products, go to

<http://www.motorola.com/homemonitoring/>

To register your product, go to

<http://broadbandregistration.motorola.com/>

### Package Contents

---

This USB Gateway package includes:

- Motorola Home Monitor software to manage cameras and sensors using your computer
- The USB Gateway to connect to your computer to locally manage your Motorola Home Monitoring & Control System through a wireless link
- A 12V power adapter

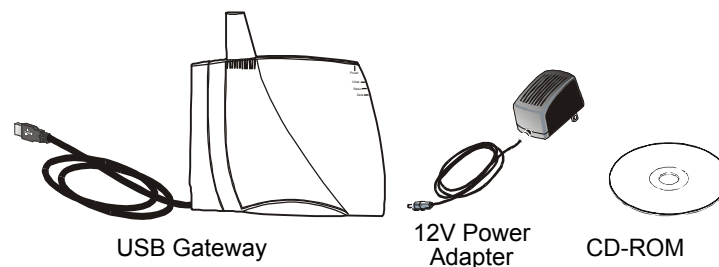

**Computer System Requirements**

- PC with Intel Pentium® II or later processor
- 2X CD-ROM drive
- USB port
- 128 MB RAM running Windows Me®, Windows® 2000, or Windows XP™ for Home or Professional
- 45 MB of hard drive space recommended for installation; 500 MB (maximum) for archives

## Installing the Software and USB Gateway

*Do not connect your USB Gateway to your computer until the Installation Wizard instructs you to do so.*

- 1 Insert the enclosed Motorola Home Monitoring & Control System CD in the CD-ROM drive. The Motorola Home Monitor Installation Wizard is displayed.
  - a If the application does not appear or autorun, right-click the Start button and select **Explore**.
  - b Select your CD-ROM and double-click to open.
  - c Double-click **Launch.exe** to start the application.
- 2 Click **Next**. The Choose Destination Location window is displayed.
- 3 Click **Next** to accept the default destination folder or click **Browse** to select a new one. After you click **Next**, the Select Program Folder window is displayed.
- 4 Accept the default folder or choose a new one. Click **Next**. The file installation begins. After a few moments, the Install Motorola Home Monitor Hardware and Driver window is displayed.
- 5 Remove the back cover from your USB Gateway.

Pull back from the top and then down. The cover will separate from the unit.

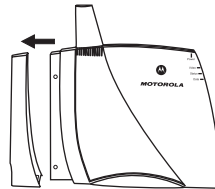

- 6 Plug the AC adapter into the **Power** port on the USB Gateway and into an AC wall outlet. This powers on your USB Gateway.
- 7 Connect the USB cable on the Gateway to the USB port on your computer. Windows automatically installs the required drivers.

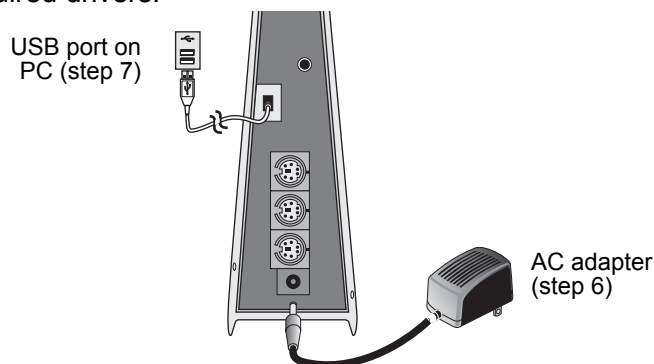

- 8 If desired, replace the USB Gateway back cover.
- 9 Once the driver installation is complete, click **Next**. The Software installation was successful window is displayed. Be sure the checkbox "Launch Motorola Home Monitor" is selected.
- 10 Click **Finish**. The Motorola Setup Wizard is displayed. Follow the on-screen instructions for installing the Motorola Home Monitor software.

## If You Need Help

---

If you encounter a problem setting up your Home Monitoring & Control System, try the following:

- Verify that you followed the steps in the order specified. Be sure you plugged in all components to AC power. If necessary, try again.
- Refer to your Motorola Home Monitoring & Control device *User Guide* (printed or on CD-ROM) and the Home Monitoring & Control System Control Panel online help.
- Check the <http://www.motorola.com/homemonitoring/> website.
- To request support seven days a week, 24 hours a day, go to <http://www.motorola.com/homemonitoring/support/emailsupport.asp> or call **(877) 466-8646**.

## Regulatory Information

---

USB Controller FCC ID NUMBER OU4-XBX200

### INSTRUCTION TO THE USER (IF DEVICE DOES NOT CONTAIN A DIGITAL DEVICE)

The user is cautioned that changes or modifications not expressly approved by the party responsible for compliance could void the user's authority to operate this equipment.

### INSTRUCTION TO THE USER (IF DEVICE CONTAINS A DIGITAL DEVICE)

This device complies with part 15 of the FCC Rules. Operation is subject to the following two conditions: (1) This device may not cause harmful interference, and (2) this device must accept any interference received, including interference that may cause undesired operation.

Note: This equipment has been tested and found to comply with the limits for a Class B digital device, pursuant to part 15 of the FCC Rules. These limits are designed to provide reasonable protection against harmful interference in a residential installation. This equipment generates, uses, and can radiate radio frequency energy and, if not installed and used in accordance with the instructions, may cause harmful interference to radio communications. However, there is no guarantee that interference will not occur in a particular installation. If this equipment does cause harmful interference to radio or television reception, which can be determined by turning the equipment off and on, the user is encouraged to try to correct the interference by one or more of the following measures:

Reorient or relocate the receiving antenna.

Increase the separation between the equipment and receiver.

Connect the equipment into an outlet on a circuit different from that to which the receiver is connected.

Consult the dealer or an experienced radio/TV technician for help.

This device must be installed and used in strict accordance with the manufacturer's instructions as described in the user documentation that comes with the product.

The term "IC:" before the certification/registration number only signifies that the Industry Canada technical specifications were met.

## Battery Life

For your Motorola Home Monitoring & Control System devices that require batteries, use high-quality, non-corrosive batteries designed for use in electronic equipment. Battery life is one year with normal usage. Do not use rechargeable batteries in any Motorola Home Monitoring & Control System device.

## Registration

Register your product at:

<http://broadbandregistration.motorola.com>



**MOTOROLA**

Copyright © 2004 by Motorola, Inc.

All rights reserved. No part of this publication may be reproduced in any form or by any means or used to make any derivative work (such as translation, transformation, or adaptation) without written permission from Motorola, Inc.

Motorola reserves the right to revise this publication and to make changes in content from time to time without obligation on the part of Motorola to provide notification of such revision or change. Motorola provides this guide without warranty of any kind, either implied or expressed, including, but not limited to, the implied warranties of merchantability and fitness for a particular purpose. Motorola may make improvements or changes in the product(s) described in this manual at any time.

MOTOROLA and the Stylized M Logo are registered in the US Patent & Trademark Office.

Intel and Pentium are registered trademarks of Intel Corporation or its subsidiaries in the United States and other countries.

Windows, Windows Me, Windows 2000, and Windows XP are registered trademarks of Microsoft Corporation.

All other product or service names are the property of their respective owners.

520623-001

11/04

MGBI

Visit our website at:  
<http://www.motorola.com/homemonitoring>



520623-001  
11/04  
MGBI